

## INSTRUCTIONS FOR USE

- 1 Secure the printed side of the wrap over the unprinted side using the Velcro as shown in figure 1. The Percussion Wrap should fit “snugly” but not tightly.
- 2 Please connect the Air Hose with the swivel connector of Percussion Wrap.

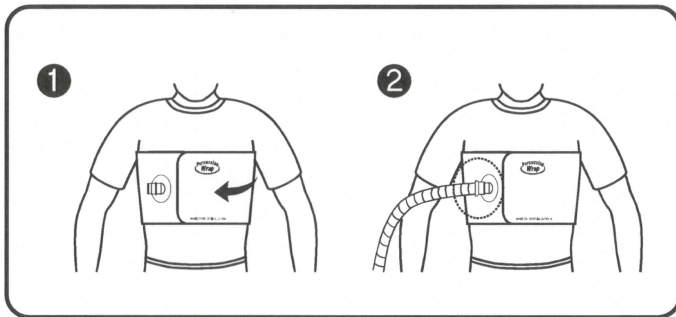

The Percussion Wrap is designed for Single Patient Use. Do not wash. ⚠

The Percussion Wrap may be used with ComfortCough Plus and ComfortVest Airway Clearance Systems.

Single Patient Use